



**IMAGINE  
PREMIUM**

A premium, single-sided cassette banner with features that include a telescopic pole, ratchet graphic tensioner, self-adhesive slide-in direct-to-roller graphic mounting, universal dual option gripper/self-adhesive slide-in top rail, anti-slip strips along the base unit, clip-in integral pole and Allen key storage. EVA molded carrying/storage bag included.

Order ref: IMG

Graphic size is variable:  
31.5" W x 29.5"H up to 83.35"H  
(+ bleed)



**EXCALIBUR**

**31.5" DOUBLE-SIDED PREMIUM**  
Premium quality, double-sided banner stand with a sleek new design, graphic tensioner, integrated pole storage & quick change graphic system. Banner stand comes complete with a telescopic pole & EVA molded carry bag.

Order ref: EXC  
Graphic size is variable: 31.5"W x 29.5"H up to 83.35"H (+ bleed).



**ADVANCE**

**31.5" DOUBLE-SIDED PREMIUM**

Advance is a premium double-sided banner stand that features a graphic tensioner, simple, drop-in cassette housing & anti-slip strips along the base. Unit is complete with a telescopic pole & EVA molded carry bag.

Order ref: ADV  
Graphic size is variable: 31.5"W x 29.5"H up to 83.35"H (+ bleed).



**BARRACUDA**

**31.5" SINGLE-SIDED PREMIUM**

A premium quality, single-sided banner stand with refined styling, a graphic tensioner, a sleek profile & quick change graphic system. Banner stand comes complete with a telescopic pole & EVA molded carry bag.

Order ref: BCD

Graphic size is variable: 31.5"W x 29.5"H up to 83.35"H (+ bleed).



**CHALLENGER**

**DOUBLE-SIDED PREMIUM**

A double sided display with the convenience of a retractable banner stand. Constructed from aluminum and steel with two built in retractor mechanisms that allow you to present two graphics back-to-back and wide stabilizing feet. Bag included.

Available in 2 Sizes and Colors

**Challenger**

High-shine Silver: CH-BF-30-S  
Silk Black: CH-BF-30-B  
Graphic size: 29.5"W x 79.5"H (+ bleed).

**Challenger Mega**

High-shine Silver: CH-BF-36-S  
Silk Black: CH-BF-36-B  
Graphic size: 35.5"W x 79.5"H (+ bleed).





**ORIENT**  
AFFORDABLE

Quick and simple to use, the Orient combines elegance with excellent value. Finished in anodized Silver with heavy duty molded end plates. Padded carry bag included.

Available in 3 Sizes

Order ref: ONT-800-S  
Graphic size: 31.5"W x 83.25"H (+ bleed).

Order ref: ONT-920-S  
Graphic size: 35.5"W x 83.25"H (+ bleed).

Order ref: ONT-1000-S  
Graphic size: 39.25"W x 83.25"H (+ bleed).



**ORIENT 2**  
AFFORDABLE DOUBLE-SIDED

A double-sided version of our top seller! Finished in Anodized Silver with heavy duty molded end plates. Padded carry bag is included.

Available in 3 Sizes

Order ref: ONT-800-DBL-S  
Graphic size: 31.5"W x 83.25"H (+bleed).

Order ref: ONT-920-DBL-S  
Graphic size: 35.5"W x 83.25"H (+ bleed).

Order ref: ONT-1000-DBL-S  
Graphic size: 39.25"W x 83.25"H (+ bleed).



**PACIFIC**  
31.5" AFFORDABLE

A quality banner stand at an affordable price that comes finished in stylish Anodized Silver with heavy duty molded end plates and a swivel-out foot. Unit is complete with a 3 piece bungee pole & padded carry bag.

Available in 3 Sizes

Order ref: PAC-800-S  
Graphic size: 31.5"W x 83.75"H (+ bleed).

Order ref: PAC-920-S  
Graphic size: 35.5"W x 83.75"H (+ bleed).

Order ref: PAC-1000-S  
Graphic size: 39.25"W x 83.75"H (+ bleed).



**CONTENDER**  
AFFORDABLE

Contender offers sturdy construction, sleek styling and height up to 106" with an optional 4th pole. A carry bag is included. Call for more info & options.

Available in 4 Sizes

Contender Mini  
High-shine Silver: CN-24-S  
Silk Black finish: CN-24-B  
Graphic size: 23.5"W x 77.5"H (+ bleed).

Contender Standard  
High-shine Silver: CN-30-S  
Silk Black finish: CN-30-B  
Graphic size: 29.5"W x 77.5"H (+ bleed).

Contender Mega  
High-shine Silver: CN-36-S  
Silk Black: CN-36-B  
Graphic size: 35.5"W x 77.5"H (+ bleed).

Contender Monster  
Silk Black: CN-48-B  
Graphic size: 47.5"W x 77.5"H (+ bleed).





**LIGHTNING**  
ECONOMY BANNER STAND  
Lightning is Light weight and easy to use with snap-lock graphic rails to make graphic changes quick and simple, and a 3 piece bungee corded pole. Comes complete with a budget carry bag.  
Order ref: LTNG  
Graphic size: 31.5"W x 77.5"H (+ bleed).

**THUNDER**  
ECONOMY TELESCOPIC BANNER STAND

Thunder's distinctive silver base and telescopic pole offer great design & versatility. Snap-lock rails help make graphic changes fast and easy while the weighted base provides a sturdy platform to display your graphic. Includes a budget carry bag.

Order ref: THDR  
Graphic size: 31.5"w x 34.25" up to 81.5" (plus bleed)





**UNO**  
TELESCOPIC BANNER STAND

The Uno banner stand features all aluminum construction and can be used with a Velcro acceptable fabric panel. Call for details. All kits include a carry bag with graphic storage.

Available in 3 Sizes

Uno Standard  
31.5" wide: UN-1-ST  
Graphic size: 31.5"W x 34.5"H  
up to 85.5"H (+ bleed).

Uno Mega  
36" wide: UN-1-MG  
Graphic size: 35.5"W x 34.5"H  
up to 85.5"H (+ bleed).

Uno Monster  
48" wide: UN-1-MO  
Graphic size 48"W x 34.5"H  
up to 85.5"H (+ bleed).



**PEGASUS**  
FULLY ADJUSTABLE TELESCOPIC BANNER STAND

Pegasus makes an excellent budget backwall or backdrop that can be used as a single or double-sided unit with dual telescopic poles (horizontal and vertical).

Available in 2 Sizes and Colors

Pegasus  
Visual minimum of  
52.5"W up to 95"W  
and from 36"H up  
to 96"H (+ bleed).

Silver finish:  
PGSUS-S

Black finish:  
PGSUS-B

Pegasus Mini  
Visual minimum of  
27.5"W up to 48"W  
and from 36.5"H up  
to 96"H (+ bleed).

Silver finish:  
PGSUS-MIN-S

Black finish:  
PGSUS-MIN-B



**DASH 1 OPTIONS**

An optional 3 pocket literature dispenser is available. When adding the literature pocket, graphic size is 31.5"W x 44"H (+ bleed).

Order ref: DSH-M-L-1

Double sided unit with 2 literature dispensers-

Order ref: DSH-M-L-2



**DASH 1**

TRIPOD TELESCOPIC BANNER STAND  
A well crafted tripod banner stand, manufactured of anodized aluminum that is very stable, quick & easy to erect. Available as a single or double sided unit. A carry bag is included.

Dash Mini single sided: DSH-M

Graphic size: 31.5"W x 78.5"H  
(+ bleed).

Dash Mini double sided: DSH-M-2

**DASH MEGA 1 & 2**

TRIPOD TELESCOPIC BANNER STAND

Dash Mega is a well crafted tripod banner stand. Manufactured of anodized aluminum, it's very stable, quick & easy to erect. Available as a single or double sided unit. A carry bag with tube is included.

Dash Mega 1 is single sided: DSH-ME

Graphic size: 36"W up to 93.5"H (+ bleed).

Dash Mega 2 is double sided: DSH-ME-2





**WIND DANCER  
TELESCOPIC OUTDOOR  
FLAGPOLE**

Wind Dancer is a great option for outdoor and indoor banner display. It offers an adjustable display height of up to 16' and comes with a hollow base allowing the option of adding either water or sand as a weighting agent. The constructed unit is easy to position, erect and remove. Complete user instructions included.  
Order ref: WIND-MX  
Graphic size: 43"W x up to 144"H (allow 2" along the top and left side for #3 grommet placement).

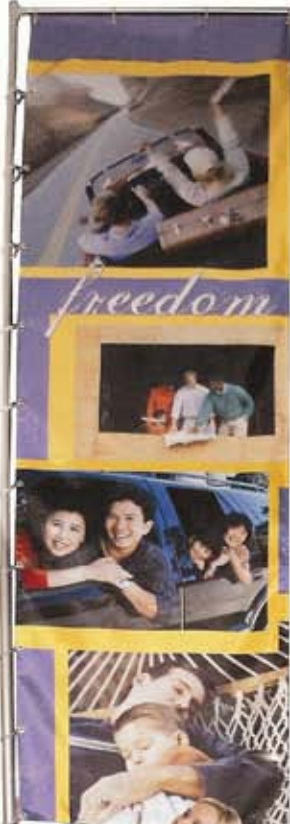

**WIND DANCER LANYARD  
FLAGPOLE OPTION**  
Allows a standard Wind Dancer unit to be converted into a flagpole.  
Order ref: WND-MX-FPCK

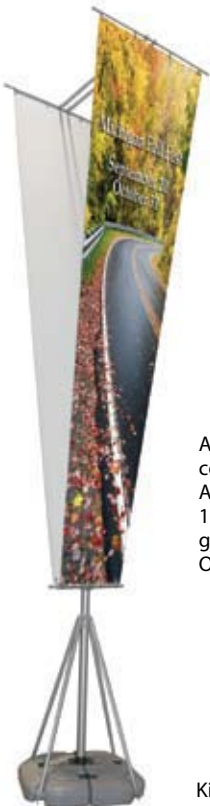

**WIND DANCER SPIRE  
DOUBLE-SIDED WIND DANCER OPTION**

Allows a standard Wind Dancer unit to be converted to a doubled-sided "V" shaped banner. Approximate graphic dimensions: 39.4"W x 157.5"H, (allow 2" along top and bottom for #3 grommet placement).  
Order ref: WIND-MX-FPCK2



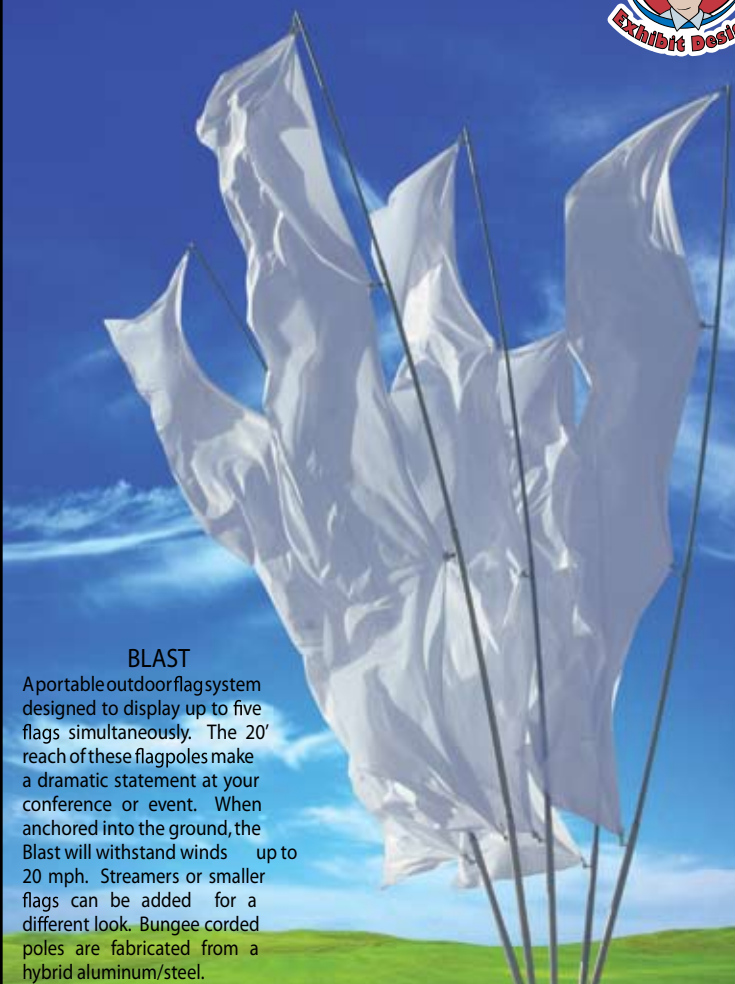

Kit includes: top and bottom pole hardware, graphic attachment rings and ring stops.



**BLAST**  
A portable outdoor flags system designed to display up to five flags simultaneously. The 20' reach of these flagpoles make a dramatic statement at your conference or event. When anchored into the ground, the Blast will withstand winds up to 20 mph. Streamers or smaller flags can be added for a different look. Bungee corded poles are fabricated from a hybrid aluminum/steel.  
The powder coated steel base comes complete with four ground spikes and a rubber mallet.  
Order ref: BLST  
Graphic size: 34"W x 173.5"H (no bleed).



**ZOOM**  
The Zoom can be used indoors or out. The unique design allows the graphic to rotate with the wind, which reduces the chance of the system being blown over. The graphic is over 8' tall when used with the floor base and close to 10' tall when using the ground spike (included). Water fillable donut weight (as pictured) and carry bags are also included. Graphics are flag material print on one side only.  
Order ref: ZOOM  
Graphic size: 45.75"W x 80"H (+ bleed).

Both the floor base and the outdoor spike base are included in the kit.



**STORM PRO**  
OUTDOOR BANNER STAND

The Storm PRO features heavy duty construction for excellent strength and stability. Each unit comes with a hollow base that can be filled with water or sand. The telescopic support pole and completely adjustable central hub allow you to vary the height of the graphic to fit your needs and rotate the graphic 45° or from horizontal to vertical. Available in a silver finish. Note: Graphic does not rotate when set to maximum height.

Single sided: STRM-PR, Double sided: STRM-PR2  
Graphic height varies: 23.5"W X 61.5"H up to 86"H (+ bleed).

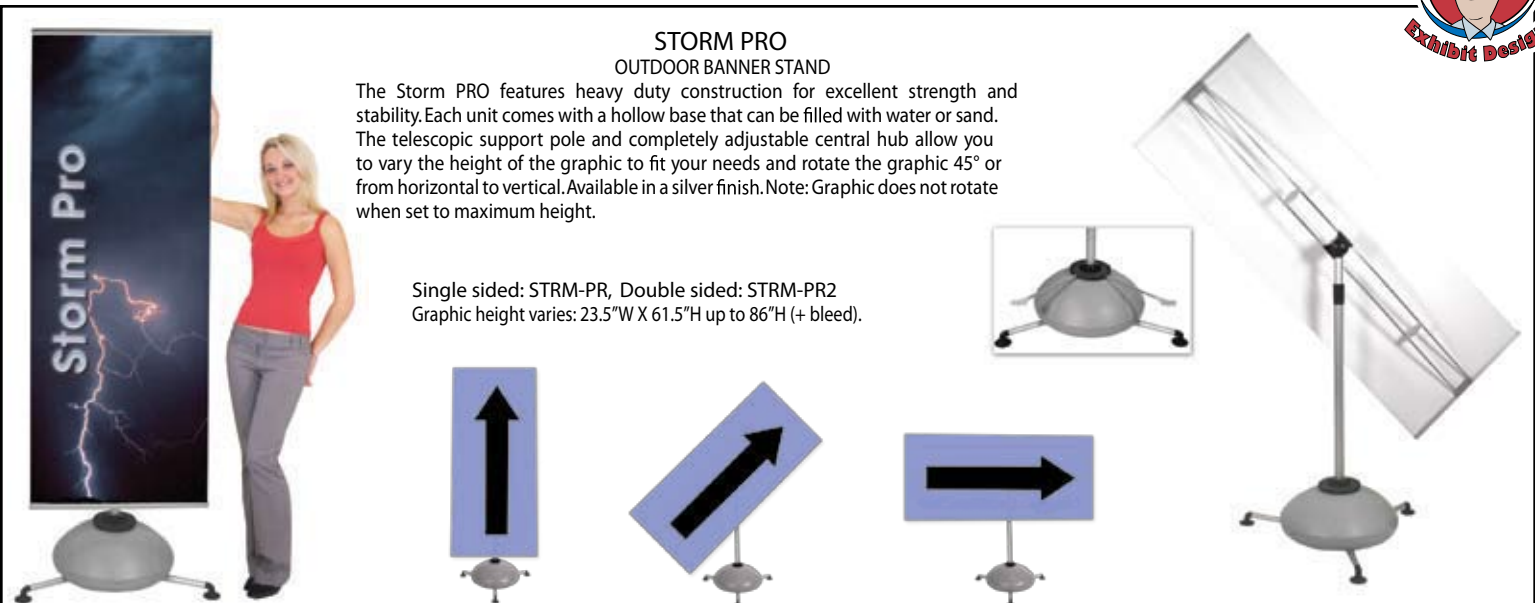

**MONSOON**

A semi-portable double sided billboard that features a strong frame that is quick and easy to assemble. Graphic size is 92.125"W x 32"H (+ bleed). Typically, a vinyl banner is secured into place by bungee rope and banner grommets. (Banner and grommets not included). Order ref: MONSN-2



**SPINNAKER**  
PORTABLE OUTDOOR  
BILLBOARD

A versatile indoor/outdoor billboard that can be used for single or double sided presentation. With a maximum graphic area of 8' wide x 8' high (weather and wind conditions permitting), it's an ideal promotional solution for outdoor events, advertisements, exhibitions and public areas such as airports and shopping centers. Units can be linked together for added impact!  
Order ref: SPKR  
Graphic size: 98"W  
Graphic height is variable:  
45" minimum up to 98" (+ bleed).



**REVOLUTION**  
MOTORIZED SCROLLING  
BANNER STAND

The Revolution is a motorized scrolling banner display system. Unlike the Maverick, the Revolution is not a floor standing unit, therefore the graphic can vary in height. It can be suspended from ceiling hooks (not included) or attached to a wall. The Revolution adds movement to practically any flat surface! Carry bag included. Graphic size: 32.5"W x 240"H (maximum height of looped graphic). Order ref: REV-850-S



**MAVERICK STANDARD**  
ECONOMY MOTORIZED  
SCROLLING BANNER STAND

Twin Telescopic arms allow you to set the height of your display from 48" up to 72". The scrolling mechanism at the top offers a wide variety of options for the length and style of your graphic. The Maverick Standard utilizes standard 110v power and comes complete with a carry bag. Graphic size: 28.75"W x 145"H (maximum height of looped graphic). Order ref: MAV-STD

